

ARLETA WEIDNER CDBG

Miguel Sangalang, Exec. Dir.
Bureau of Street Lighting
Attn: Prop. 218 Section
1149 S. Broadway, 2nd Fl.
Los Angeles CA 90015

PROJ ID / Elect. No.: 5369
COUNCIL FILE No.: 22-0900-S20
Engineer: Siraj Albouhosn
Mailing Date: 03/23/22
P.W. Hearing Date: 05/04/22
Council Hearing Date: 05/10/22

Election Division
Attn: Jennifer Bedolla
Piper Technical Center, 3rd Fl.
Mail Stop 168

Calendar Section
Attn: Melinda Novoa / Erika Pulst
Room 395, City Hall
Mail Stop 160

Councilmember Nury Martinez
6th District
Room 470, City Hall
Stop 210

	City Assmt ID	APN	Owner name	Owner address	PROPOSED ASSESSMENT
1.	15634-001	2617-017-012	CAMPOS,ARTHUR H AND BETTY L	14123 FILMORE ST ARLETA, CA 91331	\$93.73
2.	15634-002	2617-017-013	MANTUA INVESTMENTS LLC	13517 PALA AVE SYLMAR, CA 91342	\$85.21
3.	15634-003	2617-017-014	MIRANDA,LUIS M AND MAIRA R	14146 LOUVRE ST ARLETA, CA 91331	\$93.73
4.	15634-004	2617-017-015	RENERIA,ROBERTO G AND ELOISA P AND GOMEZ,RIGOBERTO	14152 LOUVRE ST ARLETA, CA 91331	\$85.21
5.	15634-005	2617-017-016	SOTELO FAMILY TRUST	14158 LOUVRE ST ARLETA, CA 91331	\$85.21
6.	15634-006	2617-017-017	SIGUENZA,EDGARDO A AND MARIA H	14164 LOUVRE ST ARLETA, CA 91331	\$85.21
7.	15634-007	2617-017-018	NOYOLA,ELIAS AND SANDRA	14163 LOUVRE ST ARLETA, CA 91331	\$85.21
8.	15634-008	2617-017-019	ESCOBEDO,GENE J AND SANDRA E	14157 LOUVRE ST ARLETA, CA 91331	\$85.21
9.	15634-009	2617-017-020	MARTINEZ,HECTOR AND MISON	14151 LOUVRE ST ARLETA, CA 91331	\$85.21
10.	15634-010	2617-017-021	LEMUS,MICHAEL J	14145 LOUVRE ST ARLETA, CA 91331	\$93.73
11.	15634-011	2617-017-022	ROXANA L VAZQUEZ TRUST	10341 LEV AVE ARLETA, CA 91331	\$85.21
12.	15634-012	2617-017-023	BAEZ,MARIBEL ET AL OROZCO,YOLANDA	14202 WEIDNER ST ARLETA, CA 91331	\$93.73
13.	15634-013	2617-017-024	KENNEDY,ALBERT JR AND RAYMUNDA	14210 WEIDNER ST ARLETA, CA 91331	\$85.21
14.	15634-014	2617-017-025	YANEZ,FERNANDO AND YANEZ,EILEEN	14216 WEIDNER ST ARLETA, CA 91331	\$85.21
15.	15634-015	2617-017-026	BAYARDO,OCTAVIO AND TINA M	14222 WEIDNER ST ARLETA, CA 91331	\$106.51
16.	15634-016	2617-017-027	DELGADO MURILLO,JUAN AND	14221 WEIDNER ST ARLETA, CA 91331	\$106.51
17.	15634-017	2617-017-028	ESCAMILLA,JOSE L AND ESCAMILLA,JUAN M	14215 WEIDNER ST ARLETA, CA 91331	\$85.21
18.	15634-018	2617-017-029	SUAREZ,IGNACIO M AND ESPERANZA AND	14209 WEIDNER ST ARLETA, CA 91331	\$85.21
19.	15634-019	2617-017-030	YVONNE L GOMEZ DECD TRUST	717 SAN FERNANDO MISSION BLVD SAN FERNANDO, CA 91340	\$93.73
20.	15634-020	2617-020-012	RODARTE,ENRIQUE AND ROSIE A ET AL	14171 WEIDNER ST ARLETA, CA 91331	\$93.73
21.	15634-021	2617-020-013	MARROQUIN,CARLOS S	14165 WEIDNER ST ARLETA, CA 91331	\$85.21

22.	15634-022	2617-020-014	ANGEL F RAMIREZ TRUST	14159 WEIDNER ST PACOIMA, CA 91331	\$85.21
23.	15634-023	2617-020-015	VALDIVIA,IRMA	14153 WEIDNER ST ARLETA, CA 91331	\$85.21
24.	15634-024	2617-020-016	RODRIGUEZ FAMILY TRUST	14147 WEIDNER ST ARLETA, CA 91331	\$85.21
25.	15634-025	2617-020-017	VANEGAS,MAURICE AND JIMINEZ,NORA	8976 LAUREL CANYON BLVD SUN VALLY, CA 91352	\$85.21
26.	15634-026	2617-020-018	YEPEZ,ANITA D AND GONZALEZ,MARGARET Y	14135 WEIDNER ST ARLETA, CA 91331	\$85.21
27.	15634-027	2617-020-019	KOLLATH,ADELINA	14129 WEIDNER ST ARLETA, CA 91331	\$85.21
28.	15634-028	2617-020-020	ARISTA,AGUSTIN E	14123 WEIDNER ST ARLETA, CA 91331	\$85.21
29.	15634-029	2617-020-021	PAPYAN,VAHAGN	14117 WEIDNER ST ARLETA, CA 91331	\$85.21
30.	15634-030	2617-020-022	ROJERO,SERAFIN AND ORTIZ,MARTINA	14111 WEIDNER ST ARLETA, CA 91331	\$85.21
31.	15634-031	2617-018-001	URENA,JOSE	14105 WEIDNER ST ARLETA, CA 91331	\$85.21
32.	15634-032	2617-018-002	ROJAS,MANUEL M AND MARTINEZ,RAMONA	14101 WEIDNER ST ARLETA, CA 91331	\$106.51
33.	15634-033	2617-018-023	MORALES,JORGE AND SANDRA	10432 VENA AVE ARLETA, CA 91331	\$106.51
34.	15634-034	2617-018-022	LIZARRAGA TRUST	10424 VENA AVE ARLETA, CA 91331	\$85.21
35.	15634-035	2617-018-021	REGIS,ANTONIO AND LIDIA	10418 VENA AVE ARLETA, CA 91331	\$85.21
36.	15634-036	2617-018-020	A AND R VILLALOBOS TRUST	10412 VENA AVE ARLETA, CA 91331	\$85.21
37.	15634-037	2617-018-019	DAVID R SALAZAR FAMILY TRUST	10406 VENA AVE ARLETA, CA 91331	\$85.21
38.	15634-038	2617-018-018	ARROYO,JOSE M AND MANUELA	10400 VENA AVE ARLETA, CA 91331	\$85.21
39.	15634-039	2617-018-017	NAVA,ARACELY AND SAMUEL	10380 VENA AVE ARLETA, CA 91331	\$85.21
40.	15634-040	2617-018-016	CASTILLO,NELSON AND NOHEMY	10374 VENA AVE ARLETA, CA 91331	\$85.21
41.	15634-041	2617-018-015	R V AND O N BELMONTES TRUST	10368 VENA AVE ARLETA, CA 91331	\$85.21
42.	15634-042	2617-018-014	JUAREZ,CLAUDIA	10360 VENA AVE ARLETA, CA 91331	\$93.73
43.	15634-043	2617-018-013	MEDINA FAMILY TRUST	10401 SHARP AVE ARLETA, CA 91331	\$93.73
44.	15634-044	2617-004-049	CHAVEZ,JUAN AND MARIA G	14000 FILMORE ST ARLETA, CA 91331	\$93.73
45.	15634-045	2617-004-048	RACHEL B LIZARRAGA TRUST	14008 FILMORE ST ARLETA, CA 91331	\$85.21
46.	15634-046	2617-004-047	HERNANDEZ,TERESA AND HERNANDEZ,ROLANDO	14014 FILMORE ST ARLETA, CA 91331	\$85.21
47.	15634-047	2617-004-046	ARIAS,ENRIQUE AND MARIA F	14018 FILMORE ST ARLETA, CA 91331	\$85.21
48.	15634-048	2617-004-044	ALVARADO,JOSE A	14024 FILMORE ST ARLETA, CA 91331	\$85.21
49.	15634-049	2617-004-043	CABRERA,RIGOBERTO AND ZOILA A	14028 FILMORE ST ARLETA, CA 91331	\$85.21
50.	15634-050	2617-005-039	RODRIGUEZ,SANDRA V AND GARCIA,JUAN C	14036 FILMORE ST ARLETA, CA 91331	\$85.21
51.	15634-051	2617-005-038	ORTEGA FAMILY TRUST	14040 FILMORE ST ARLETA, CA 91331	\$85.21
52.	15634-052	2617-005-037	CARLE,CAROL	14046 FILMORE ST ARLETA, CA 91331	\$85.21
53.	15634-053	2617-005-036	RAMIREZ,JOAQUIN AND REINA	11867 PASO ROBLES AVE GRANADA HILLS, CA 91344	\$85.21
54.	15634-054	2617-005-035	ROMELIA MENDOZA TRUST	14058 FILMORE ST ARLETA, CA 91331	\$93.73
55.	15634-055	2617-006-051	RAMIREZ,TONY JR AND CHAVARRIA,SANTOS P	14066 FILMORE ST ARLETA, CA 91331	\$93.73
56.	15634-056	2617-006-050	VALDEZ,CONSTANTINO AND MARIA	14072 FILMORE ST ARLETA, CA 91331	\$85.21
57.	15634-057	2617-006-049	MENDOZA,SONIA	14100 FILMORE ST ARLETA, CA 91331	\$85.21
58.	15634-058	2617-006-048	FERNANDEZ,PEDRO AND GLORIA	14104 FILMORE ST ARLETA, CA 91331	\$85.21
59.	15634-059	2617-006-047	CHACON FAMILY TRUST	14108 FILMORE ST ARLETA, CA 91331	\$93.73
60.	15634-060	2617-019-026	MORENO,ARTURO AND MAGALI	10361 VENA AVE ARLETA, CA 91331	\$93.73

61.	15634-061	2617-019-027	RAMIREZ,SEIN M JR AND LIZBETH	10369 VENA AVE ARLETA, CA 91331	\$85.21
62.	15634-062	2617-019-028	JULIO,HORACIO	10375 VENA AVE ARLETA, CA 91331	\$85.21
63.	15634-063	2617-019-029	HEREDIA,ARTHURO R AND MARIA T	10381 VENA AVE ARLETA, CA 9405	\$85.21
64.	15634-064	2617-019-030	TORRES,MARIA E AND REYNAGA,MARIA D	7320 LENNOX AVE NO E4 VAN NUYS, CA 9405	\$85.21
65.	15634-065	2617-019-031	ROSALES,CARMELO AND AURORA	10407 VENA AVE ARLETA , CA 91331	\$85.21
66.	15634-066	2617-019-032	LEON,JOSE AND MARIA	10413 VENA AVE ARLETA, CA 91331	\$85.21
67.	15634-067	2617-019-001	LINAN,THIRZA AND ARMANDO	14108 WEIDNER ST ARLETA , CA 91331	\$93.73
68.	15634-068	2617-019-002	SANCHEZ,JAVIER AND GUADALUPE	14114 WEIDNER ST ARLETA , CA 91331	\$85.21
69.	15634-069	2617-019-003	LOPEZ,RUBEN R	14120 WEIDNER ST ARLETA , CA 91331	\$85.21
70.	15634-070	2617-019-004	REGIS,CYNTHIA	14126 WEIDNER ST ARLETA , CA 91331	\$85.21
71.	15634-071	2617-019-005	PEREZ,JAVIER	14132 WEIDNER ST ARLETA , CA 91331	\$85.21
72.	15634-072	2617-019-006	MIRANDA,MARTIN C AND CASTREJON,LUCIA B	14138 WEIDNER ST ARLETA , CA 91331	\$85.21
73.	15634-073	2617-021-001	LOPEZ,EUTIMIO	14144 WEIDNER ST ARLETA , CA 91331	\$85.21
74.	15634-074	2617-021-002	LOPEZ,RUBEN F	14150 WEIDNER ST ARLETA , CA 91331	\$85.21
75.	15634-075	2617-021-003	TORRES,JORGE	8347 KENTLAND AVE WEST HILLS, CA 91304	\$85.21
76.	15634-076	2617-021-004	SANTOS TRUST	14162 WEIDNER ST ARLETA, CA 91331	\$85.21
77.	15634-077	2617-021-005	ESPARZA,ROSANA AND ESPARZA,MARIA D	14170 WEIDNER ST ARLETA, CA 91331	\$93.73
78.	15634-078	2617-021-006	RAMIREZ,GABRIELA M AND MARVIN A	10338 LEV AVE ARLETA, CA 91331	\$85.21
79.	15634-079	2617-021-007	GONZALEZ,JESUS AND ANGELICA	10332 LEV AVE ARLETA, CA 91331	\$85.21
80.	15634-080	2617-021-008	SAYEB,SM AND FATEMA	10326 LEV AVE ARLETA, CA 91331	\$85.21
81.	15634-081	2617-021-009	DEL TORO,ALDO AND YESENIA	10320 LEV AVE ARLETA, CA 91331	\$85.21
82.	15634-082	2617-021-010	MORENO,EDWARD A	10314 LEV AVE ARLETA, CA 91331	\$85.21
83.	15634-083	2617-021-011	LIEVANOS,EDUARDO AND LARA,NEREIDA	10308 LEV AVE ARLETA, CA 91331	\$85.21
84.	15634-084	2617-021-012	ALICIA PENA TRUST	10300 LEV AVE ARLETA, CA 91331	\$93.73
85.	15634-085	2617-021-013	VILLAGRAN,JOSE AND DORA F AND VILLAGRAN,DORA R	10321 BARTEE AVE ARLETA, CA 90331	\$93.73
86.	15634-086	2617-021-014	SANDOVAL,JOSE R AND JOSEFINA	10327 BARTEE AVE ARLETA, CA 90331	\$85.21
87.	15634-087	2617-021-015	MARTINEZ,MAGDALENA L	4925 LIVE OAK LN CUDAHY, CA 90201	\$85.21
88.	15634-088	2617-021-016	CORTEZ,ANTEMIO JR	10339 BARTEE AVE ARLETA, CA 91326	\$85.21
89.	15634-089	2617-021-017	PENA,CARMEN	10345 BARTEE AVE ARLETA, CA 91326	\$85.21
90.	15634-090	2617-021-018	TAPIA,MARIA AND LOPEZ,PEDRO M AND ALMA L	18209 LUDLOW ST NORTHRIDGE, CA 91326	\$106.51
91.	15634-091	2617-021-019	C/O C/O INVITATION HOMES	1717 MAIN ST STE 2000 DALLAS, TX 75201	\$85.21
92.	15634-092	2617-019-007	CEJA,SALVADOR AND MARIA AND CHAVEZ,RAMIRO AND CELIA	10255 VENA AVE ARLETA, CA 91331	\$106.51
93.	15634-093	2617-019-008	MENDEZ,MARICELA G AND CEJA,JUAN C	10344 BARTEE AVE ARLETA, CA 91331	\$85.21
94.	15634-094	2617-019-009	MARQUEZ,DAVID	14265 VAN NUYS BLVD UNIT 18 ARLETA, CA 91331	\$85.21
95.	15634-095	2617-019-010	TORRES,LUIS A AND MONTOYA,LEYDY P	10322 BARTEE AVE ARLETA, CA 91331	\$85.21
96.	15634-096	2617-019-011	MONTES,CLAUDIA AND MONTES,TUOM	7653 SANCOLA AVE SUN VALLY, CA 91352	\$85.21
97.	15634-097	2617-019-012	MEDINA,REINA I	10320 BARTEE AVE ARLETA, CA 91331	\$93.73
98.	15634-098	2617-019-013	LOPEZ,LUIS AND CELIA	10341 PATRICK AVE ARLETA, CA 91331	\$93.73
99.	15634-099	2617-019-014	ZUNIGA AMADOR,HILDA Y AND AMADOR,MIGUEL A	10347 PATRICK AVE ARLETA, CA 91331	\$85.21

100.	15634-100	2617-019-015	MORAN,MANUEL I AND SUSANA	10353 PATRICK AVE ARLETA, CA 91331	\$85.21
101.	15634-101	2617-019-016	O AND J GONZALEZ TRUST	10359 PATRICK AVE ARLETA, CA 91331	\$85.21
102.	15634-102	2617-019-017	HIERRO,ERNEST AND RUTH	10365 PATRICK AVE ARLETA, CA 91331	\$85.21
103.	15634-103	2617-019-018	LAS TORRES DE TOTOTLAN TRUST	10371 PATRICK AVE ARLETA, CA 91331	\$106.51
104.	15634-104	2617-019-019	JOVITA M CABRERA TRUST	10380 PATRICK AVE ARLETA, CA 91331	\$85.21
105.	15634-105	2617-019-020	ESPARZA,MISAEAL	10370 PATRICK AVE ARLETA, CA 91331	\$106.51
106.	15634-106	2617-019-021	VASQUEZ,JOSE A AND ERICA P	10364 PATRICK AVE ARLETA, CA 91331	\$85.21
107.	15634-107	2617-019-022	DIAZ,ABELARDO AND DIAZ,MIRNA	10358 PATRICK AVE ARLETA, CA 91331	\$85.21
108.	15634-108	2617-019-023	CATALINA A VASQUEZ TRUST	10352 PATRICK AVE ARLETA, CA 91331	\$85.21
109.	15634-109	2617-019-024	NAVARRO,ARAM AND CAMPOS,KARLA G	10346 PATRICK AVE ARLETA, CA 91331	\$85.21
110.	15634-110	2617-019-025	REBOLLEDO,GABRIEL AND MARIA	10340 PATRICK AVE ARLETA, CA 91331	\$93.73

Total: \$9,713.90

END - THIS LIST IS SUBJECT TO CORRECTION

**CERTIFICATION OF MAILING NOTICES OF
STREET LIGHTING MAINTENANCE**

(Section 6.95 to 6.127 of the
Los Angeles Administrative Code)

I, Ruben Flamenco, hereby certify and declare that I am and was at all times herein mentioned a Deputy City Clerk of the City of Los Angeles; that, acting for and under the direction of the City Clerk and in accordance with the direction contained in Ordinance of Intention No(s). 187447 relating to the proposed maintenance of lighting posts and appliances and furnishing of electric current thereto in the above designated lighting district, under provisions of Sections 6.95 to 6.127 of the Los Angeles Administrative Code. I, on Mar 23, 2022 deposited in the United States mail at Los Angeles, California, a notice entitled "Notice of Public Hearings and Ballot for Operation of Streetlights," to each of the owners of real property within the Street Lighting maintenance assessment district:

ARLETA WEIDNER CDBG

whose names and addresses appear on the last equalized assessment roll of the County of Los Angeles, or on file in the office of, and known to the City Clerk of the City of Los Angeles and that a true copy of such notice is attached hereto and made a part hereof.

I certify (or declare) under penalty of perjury that the foregoing is true and correct. At Los Angeles, California

Mar 23, 2022
Date

Ruben Flamenco
DEPUTY CITY CLERK

SAMPLE BALLOT

STREET LIGHTING DISTRICT : "ARLETA WEIDNER CDBG"

PROPERTY OWNER :

VOTE HERE

YES, I am IN FAVOR of the proposed Street Lighting Assessment District. I understand that I will be assessed \$93.73 annually for the operation and maintenance of the street light(s) adjacent to my property.

NO, I am OPPOSED to the proposed Street Lighting Assessment District. I understand that a majority NO vote will cause the streetlight(s) not to be installed; or if already installed, turned off and removed from service.

Election: 5369
City Parcel: 15634-001
County APN: 2617-017-012

I hereby declare, under penalty of perjury under the laws of the State of California, that I am the record owner, or the authorized representative of the record owner, of the parcel identified above.

(Both Name and Original Signature must be completed in order for your ballot to be counted.)

PRINT NAME

(Property Owner, Authorized Rep., etc.)

ORIGINAL SIGNATURE

DATE

INSTRUCTIONS

1. Vote by marking one of the boxes on the reverse side of this ballot - Mark only one box.
2. Mark your ballot with blue or black ink - Do not use pencil.
3. Print your name, sign and date the ballot - If more than one owner, only one owner needs to sign.
4. Return the ballot using the enclosed envelope.
5. Make sure the Los Angeles City Clerk address on the back of the ballot appears in the window of the return envelope.
6. Ballot must be received by Tuesday, May 10, 2022

LOS ANGELES CITY CLERK, ELECTION DIV.
ATTN: 218 BALLOT ST. LTG. MNT. # 5369
555 RAMIREZ STREET, SPACE 300
LOS ANGELES, CA 90099-9716

As a covered entity under Title II of the Americans with Disabilities Act, the City of Los Angeles does not discriminate on the basis of disability and upon request will provide reasonable accommodation to ensure equal access to its programs, services and activities.



NOTICE TO PROPERTY OWNERS

FOR THE FORMATION OF THE CITY OF LOS ANGELES
STREET LIGHTING MAINTENANCE DISTRICT:

ARLETA WEIDNER CDBG

NOTE: Ballots must be received by Tuesday, May 10, 2022



*This package contains a ballot to determine if streetlights adjacent to your property will be installed.
Este paquete contiene una boleta de votación si a luces adyacentes a su propiedad son instalada.*

In order to provide street lighting services near your property, an assessment district must be created to collect the annual cost for street lighting operation and maintenance from the adjacent property owners. This is your opportunity to vote (see instructions on back of ballot) on whether you want to have streetlights and accept the assessment added to your property taxes to pay for these costs.

NOTICE

This notice informs you, as record owner of property within the proposed assessment district, which on 3/8/2022 the Los Angeles City Council declared its intention to form a new Street Lighting Maintenance District, under Council File number 22-0900-S20. All interested persons are invited to attend the public hearings and express opinions on the proposed assessment.

Public Hearing: Wednesday, May 4, 2022, 10:00 AM
Board of Public Works – 3rd fl., Rm. 350, City Hall, 200 N. Spring Street.

Council Hearing: Tuesday, May 10, 2022, 10:00 AM
Los Angeles City Council – 3rd fl., Rm. 340, City Hall, 200 N. Spring Street.

Protest Procedure: Protests presented for consideration to the Council are not binding, regardless of the number. The Council may accept or deny the protest(s) at its discretion. Any person may file a written protest or appeal with the City Clerk at any time prior to, or on the day of, the final public hearing by the City Council on this matter. Written protests shall specify the ground(s) upon which the protest is based, the name and mailing address of the person protesting, a description sufficient to identify the property for which the protest is being filed, the Council File number, and be mailed or delivered to the City Clerk, Room 395, Los Angeles City Hall, 200 N. Spring St., Los Angeles, CA 90012.

ASSESSMENT INFORMATION

The proposed assessment described in this Notice is new and, if approved, will appear on your property tax bill. Proposition 218, the "Right to Vote on Taxes Act", was approved on the November 1996 statewide ballot, and added Article XIID to the California Constitution. It requires that a parcel's assessment may not exceed the reasonable cost for the proportional special benefit conferred on that parcel. Article XIID provides that only special benefits are assessable and the City must separate the general benefits from the special benefits. It also requires that publicly owned properties, which benefit from the improvements, be assessed.

1. **Proposed Annual Assessment (Your Property):** \$93.73 for FY 2021-22. *
2. **Proposed Annual Assessment (Entire District):** \$9,713.90 for FY 2021-22.
3. **Duration of the Proposed Assessment:** Annually on your Property Tax Bill.
4. **Reason for the Assessment:** To pay for the cost of operating, servicing and maintaining local street lighting. These costs include, but are not limited to electricity, lamps, fixtures, poles, wires, repair crews and vehicles and other items necessary to operate streetlights in the City of Los Angeles.
5. **Balloting Results:** The District will be formed and the assessment in the amount listed on the enclosed ballot will be imposed unless a majority of the ballots are returned opposing the assessment. Ballots are weighted proportionally by each parcel's assessment amount. (\$1 = 1 vote.)



Proposed Assessment Calculation

The process of determining maintenance assessments for each parcel is based on evaluating three areas relative to the amount of special benefit received. These include the size of the property, the land use, and the type of street lighting system(s) benefiting the property. These factors are evaluated for your property to determine your annual assessment. For more detailed information regarding assessment calculations, please visit us at: www.lacity.org/bsl

Questions?

Call (213) 847-1500 or visit the Bureau of Street Lighting website: www.lacity.org/bsl

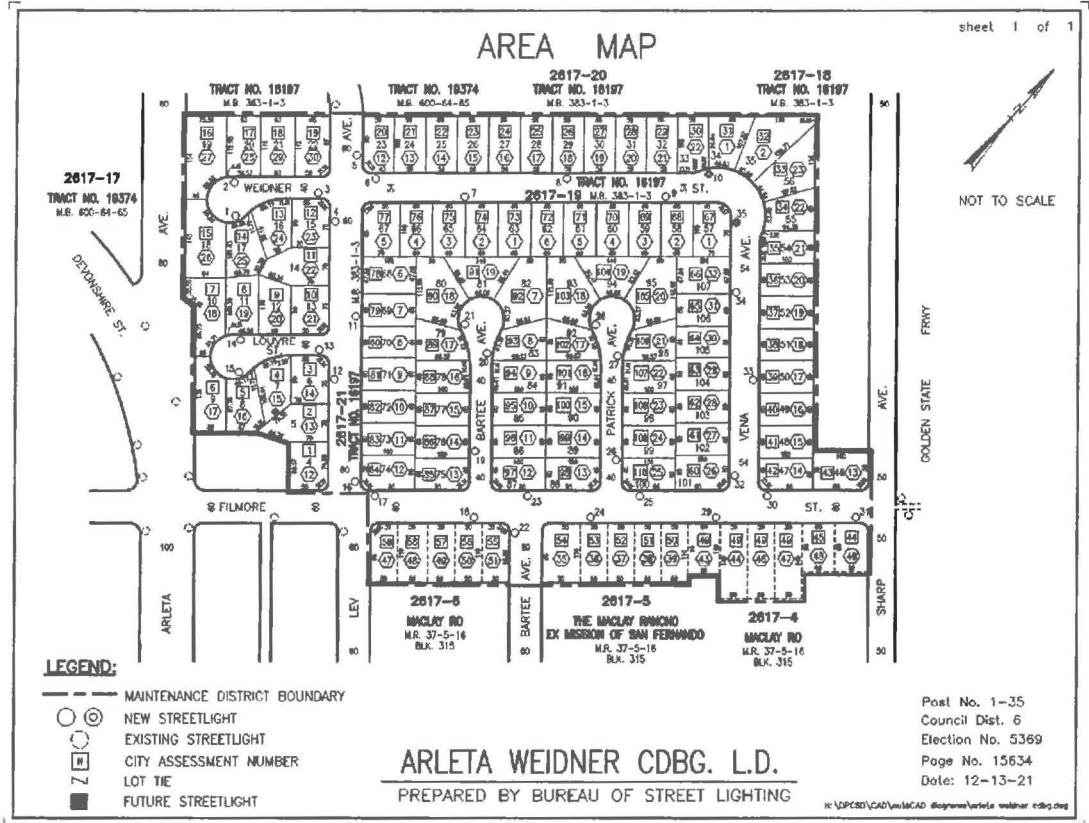

PROPERTY and ASSESSMENT DETAILS

- Location: 14123 FILMORE ST LOS ANGELES CA 91331
- County APN: 2617-017-012
- Fiscal Year: 2021-22
- Acreage: .1446
- Land Use: SFR
- Dwell Units: 1
- Current Assessment: \$74.29
- Proposed Assessment: \$93.73 *
(this equates to about \$7.81 per month)

* Assessments may be increased annually without further notice or ballot, by no more than the annual Consumer Price Index (CPI) for Los Angeles area, provided by the U.S. Dept. of Labor (Bureau of Labor Statistics). The annual Consumer Price Index (CPI) will be calculated from the calendar year (Jan 1-Dec 31) just prior to the assessment period affected (Jul 1-Jun 30). Current Assessment will be replaced by Proposed Assessment.



City of Los Angeles
Department of Public Works
Bureau of Street Lighting

SAMPLE NOTICE

Light not yet installed.

STREET LIGHTING BALLOT DON'T THROW AWAY

This package contains a ballot to determine if streetlights will be installed adjacent to your property.

In order to install streetlights near your property, an Assessment District must be created to collect the annual cost from adjacent property owners to operate and maintain the lights. This is your opportunity to vote on whether you want to have streetlights and accept the charge added to your property taxes to pay these costs.

In this packet you will find a blue Notice, a yellow Ballot, and an envelope for mailing the ballot.

Street Lighting Operation and Maintenance Ballot

This ballot is the most important document in this material.
It shows the proposed assessment amount for your property.
Ballots that are not returned, or that are returned late, cannot be counted.

Please return your ballot!

Notice to Property Owners

This Notice provides you with legally required information about the balloting and the assessment. On the back, it explains how your assessment is calculated.

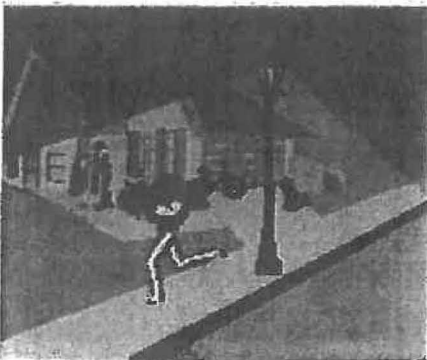

✓ A majority **YES** vote will permit the City to install streetlights near your property.

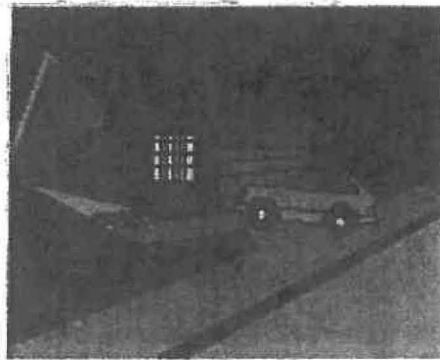

✓ A majority **NO** vote will not allow the City to install streetlights adjacent to your property.

City of Los Angeles
Dept. of Public Works
Bureau of Street Lighting



Questions? Problems paying?
Call 213 847-1500 or visit the
Bureau of Street Lighting website.
<https://bsl.lacity.org>

As a covered entity under Title II of the Americans with Disabilities Act, the City of Los Angeles does not discriminate on the basis of disability and upon request will provide reasonable accommodation to ensure equal access to its programs, services and activities.

BALOTA DE ALUMBRADO PUBLICO FAVOR DE NO TIRAR A LA BASURA

Este paquete contiene una balota para determinar si un sistema de alumbrado público será instalado adyacente a su propiedad.

Para instalar un sistema de alumbrado público cerca de su propiedad, un distrito de valoración debe ser creado para colectar anualmente de los propietarios la cantidad para la operación y mantenimiento del alumbrado. Esta es su oportunidad para votar si desea que el alumbrado se mantenga encendido y aceptar que los cargos se agregen a los impuestos de su propiedad.

En este paquete usted encontrará un aviso color azul, una balota amarilla, y un sobre para enviar la balota.

Balota para la Operación y Mantenimiento del Alumbrado Público

Esta balota es el documento más importante dentro de este material.
La balota muestra la propuesta cantidad de tasación sobre su propiedad.
Balotas no regresadas o regresadas tarde, no pueden ser contadas.

Favor de Regresar la Balota!

Aviso Para Propietarios

Este aviso suministra información sobre la votación y tasación requerida por la ley. Al reverso, le explica como su tasación es calculada.

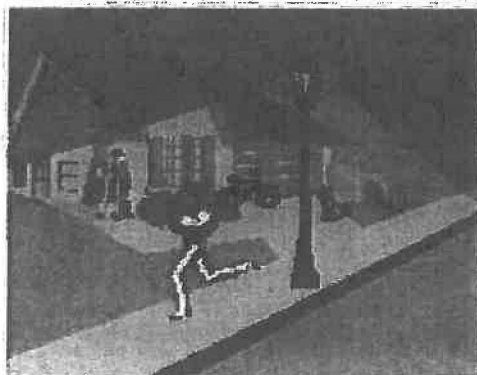

✓ Una mayoría de votos "SI", permitirá a la Ciudad instalar alumbrado público cerca de su propiedad.

✓ Una mayoría de votos "NO", no requerirá a la Ciudad instalar alumbrado público adyacente a su propiedad.

Ciudad de los Angeles
Departamento de Obras Públicas
Buró de Alumbrado Público



¿Preguntas? ¿No puede pagar?
Llame al 213 847-1500 o visite
la página de internet del Buró de
Alumbrado publico:
<https://bsl.lacity.org>

La Ciudad de Los Angeles, como ser bajo el "Title II of the Americans with Disability Act", no discrimina en base de incapacidad y al ser solicitado proveerá facilidades razonables para asegurar el acceso a sus programas, servicios y actividades.