

**ORDINANCE NO. \_\_\_\_\_**

An ordinance amending Section 12.04 of the Los Angeles Municipal Code by amending the zoning map.

**THE PEOPLE OF THE CITY OF LOS ANGELES**

**DO HEREBY ORDAIN AS FOLLOWS:**

**Sec. 1.** Pursuant to Section 12.04 and Los Angeles Municipal Code (LAMC) Section 13B.1.4 of Chapter 1A of the Los Angeles Municipal Code is hereby amended by changing the zone classifications and height district on properties shown upon portions of the Zoning Map entitled “El Sereno/ 710 Corridor Zone Change Areas” and the table for Section 1 below and incorporated herein by this reference, and made a part of Article 2, Chapter 1 of the Los Angeles Municipal Code.

**Table 1 for Section 1**

Existing Zone	New Zone
PF-1	R1-1, RD1.5-1XL, and C2-1VL
R1-1-HPOZ	OS-1-HPOZ
R1-1	RD1.5-1XL, and R3-1
R4-1-HPOZ	R3-1-HPOZ

**Sec. 2.** Pursuant to Los Angeles Municipal Code (LAMC) Section 13B.1.4 of Chapter 1A, and any amendment thereto, the use of that property described in Section 1 thereof are subject to the regulations of the R1-1, RD1.5-1XL, C2-1VL, OS-1-HPOZ, and R3-1-HPOZ zones pursuant to Sections 12.04.05, 12.08, 12.09.1, 12.10, and 12.14 of the Los Angeles Municipal Code.

**Sec. 3.** Severability. If any provision of this ordinance is found to be unconstitutional or otherwise invalid by any court of competent jurisdiction, that invalidity shall not affect the remaining provisions of this ordinance, which can be implemented without the invalid provisions and, to this end, the provisions of this ordinance are declared to be severable. The City Council hereby declares that it would have adopted each and every provision and portion thereof not declared invalid or unconstitutional, without regard to whether any portion of the ordinance would be subsequently declared invalid or unconstitutional.

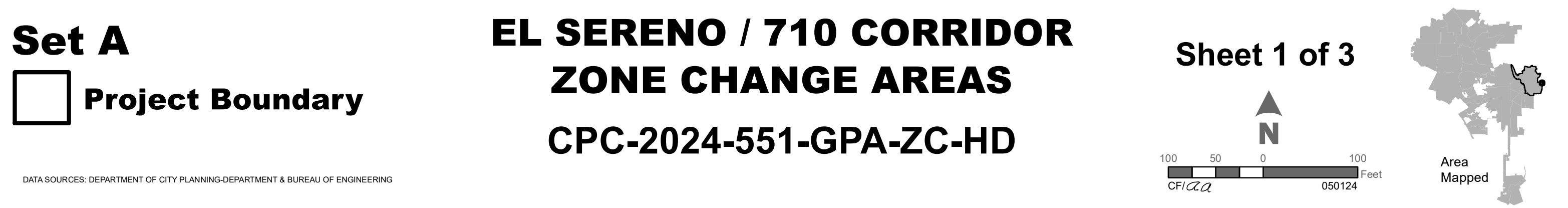

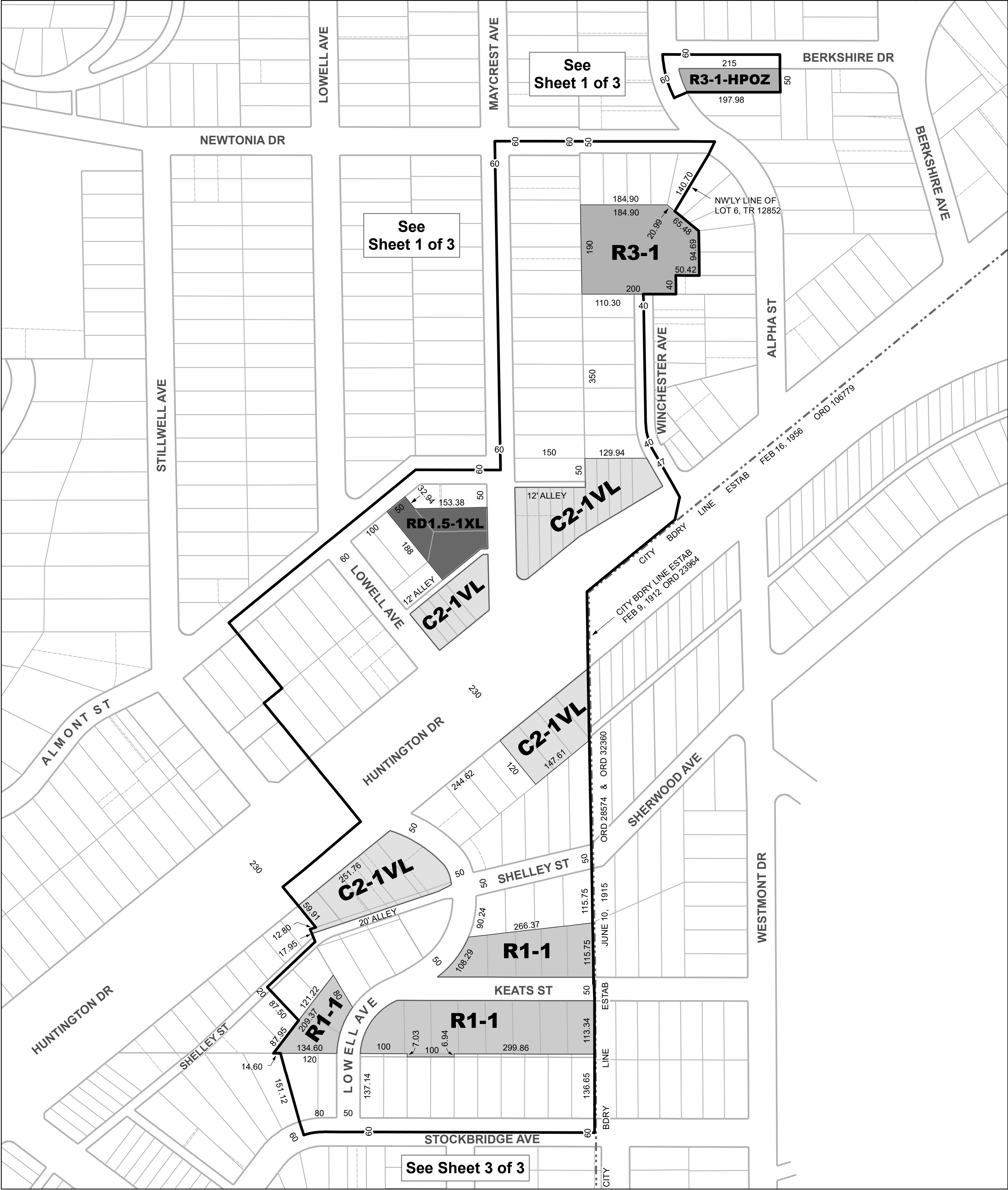

**Set A**

 **Project Boundary**

**EL SERENO / 710 CORRIDOR**

**ZONE CHANGE AREAS**

**CPC-2024-551-GPA-ZC-HD**

Sheet 2 of 3

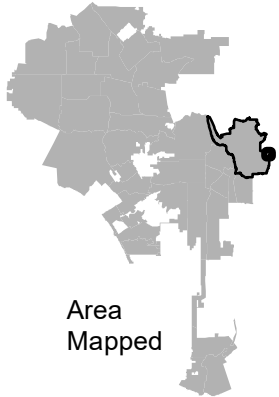
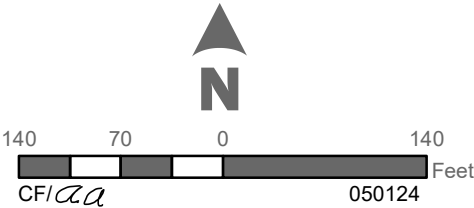

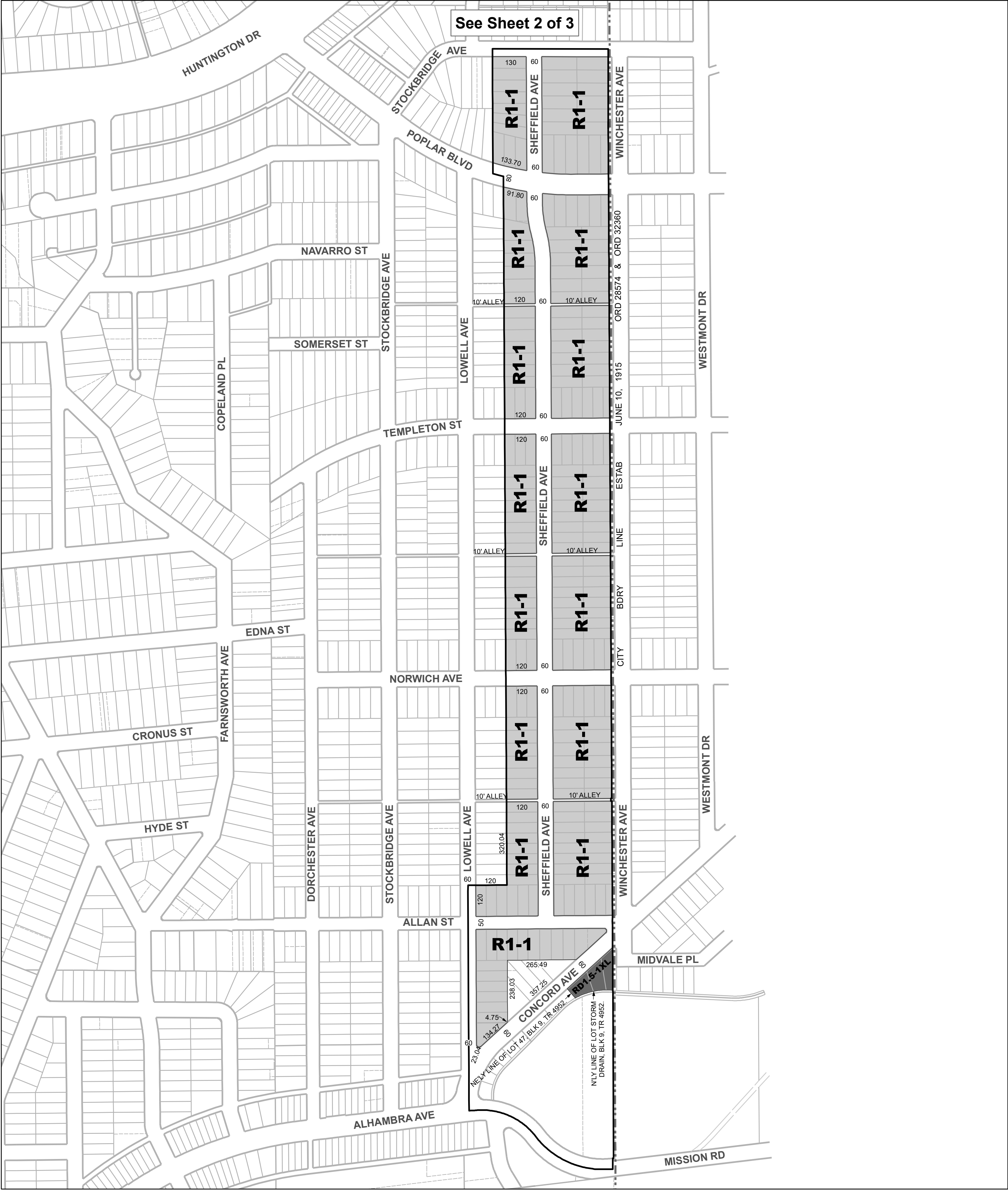

**Set A**

 **Project Boundary**

**EL SERENO / 710 CORRIDOR**

**ZONE CHANGE AREAS**

**CPC-2024-551-GPA-ZC-HD**

Sheet 3 of 3

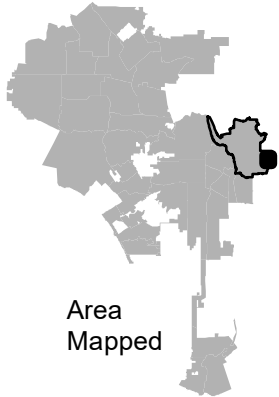
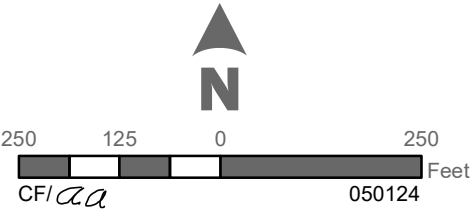

**Sec. 4.** The City Clerk shall certify to the passage of this ordinance and have it published in accordance with Council policy, either in a daily newspaper circulated in the City of Los Angeles or by posting for ten days in three public places in the City of Los Angeles: one copy on the bulletin board located at the Main Street entrance to the Los Angeles City Hall; one copy on the bulletin board located at the Main Street entrance to the Los Angeles City Hall East; and one copy on the bulletin board located at the Temple Street entrance to the Los Angeles County Hall of Records.

Pursuant to Section 559 of the City Charter, the City Planning Commission on **June 13, 2024** recommends this ordinance **BE ADOPTED** by the City Council.

By  \_\_\_\_\_  
Cecilia Lamas  
Commission Executive Assistant II

File No. \_\_\_\_\_

CITY CLERK

MAYOR

\_\_\_\_\_

\_\_\_\_\_

Ordinance Passed \_\_\_\_\_

Approved \_\_\_\_\_