

**ORDINANCE NO. \_\_\_\_\_**

An ordinance amending Section 12.04 of the Los Angeles Municipal Code by amending the zoning map.

**THE PEOPLE OF THE CITY OF LOS ANGELES  
DO ORDAIN AS FOLLOWS:**

**SECTION 1.** The Zoning Map, as provided in Los Angeles Municipal Code (LAMC) Section 12.04, for the properties shown in the Maps, attached as Hillside Construction Regulation "HCR" District Zone Change Maps (1 through 4) to this Ordinance and incorporated herein by this reference, is amended by changing the zone classifications as provided in the "Table for Section 1," below.

**Table 1 for Section 1**

<b>Existing Zone</b>	<b>New Zone</b>
RE40-1-H	RE40-1-H-HCR
RE40-1-H-RPD	RE40-1-H-RPD-HCR
RE15-1	RE15-1-HCR
RE15-1D	RE15-1D-HCR
RE15-1-H	RE15-1-H-HCR
RE15-1-H#	RE15-1-H#-HCR
RE11-1	RE11-1-HCR
RE11-1D	RE11-1D-HCR
RE9-1	RE9-1-HCR
RE9-1D	RE9-1D-HCR
R2-1XL	R2-1XL-HCR
R1-1	R1-1-HCR
R1-1D	R1-1D-HCR
RD4-1XL	RD4-1XL-HCR
RD1.5-1XL	RD1.5-1XL-HCR
R3-1	R3-1-HCR

**SECTION 2.** A property shown in the Maps attached as Hillside Construction Regulation "HCR" District Zone Change Maps (1 through 4) is subject to the Hillside Construction Regulation "HCR" Supplemental Use District regulations in Los Angeles Municipal Code Section 13.20, including as it may be amended from time to time.

The following Hillside Construction Regulation "HCR"  
District Zone changes apply to all four maps.

FROM RE40-1-H	TO RE40-1-H-HCR
FROM RE40-1-HRPD	TO RE40-1-HRPD-HCR
FROM RE15-1	TO RE15-1-HCR
FROM RE15-1D	TO RE15-1D-HCR
FROM RE15-1-H	TO RE15-1-H-HCR
FROM RE15-1-H#	TO RE15-1-H#-HCR
FROM RE11-1	TO RE11-1-HCR
FROM RE11-1D	TO RE11-1D-HCR
FROM RE9-1	TO RE9-1-HCR
FROM RE9-1D	TO RE9-1D-HCR
FROM R2-1XL	TO R2-1XL-HCR
FROM R1-1	TO R1-1-HCR
FROM R1-1D	TO R1-1D-HCR
FROM RD4-1XL	TO RD4-1XL-HCR
FROM RD1.5-1XL	TO RD1.5-1XL-HCR
FROM R3-1	TO R3-1-HCR

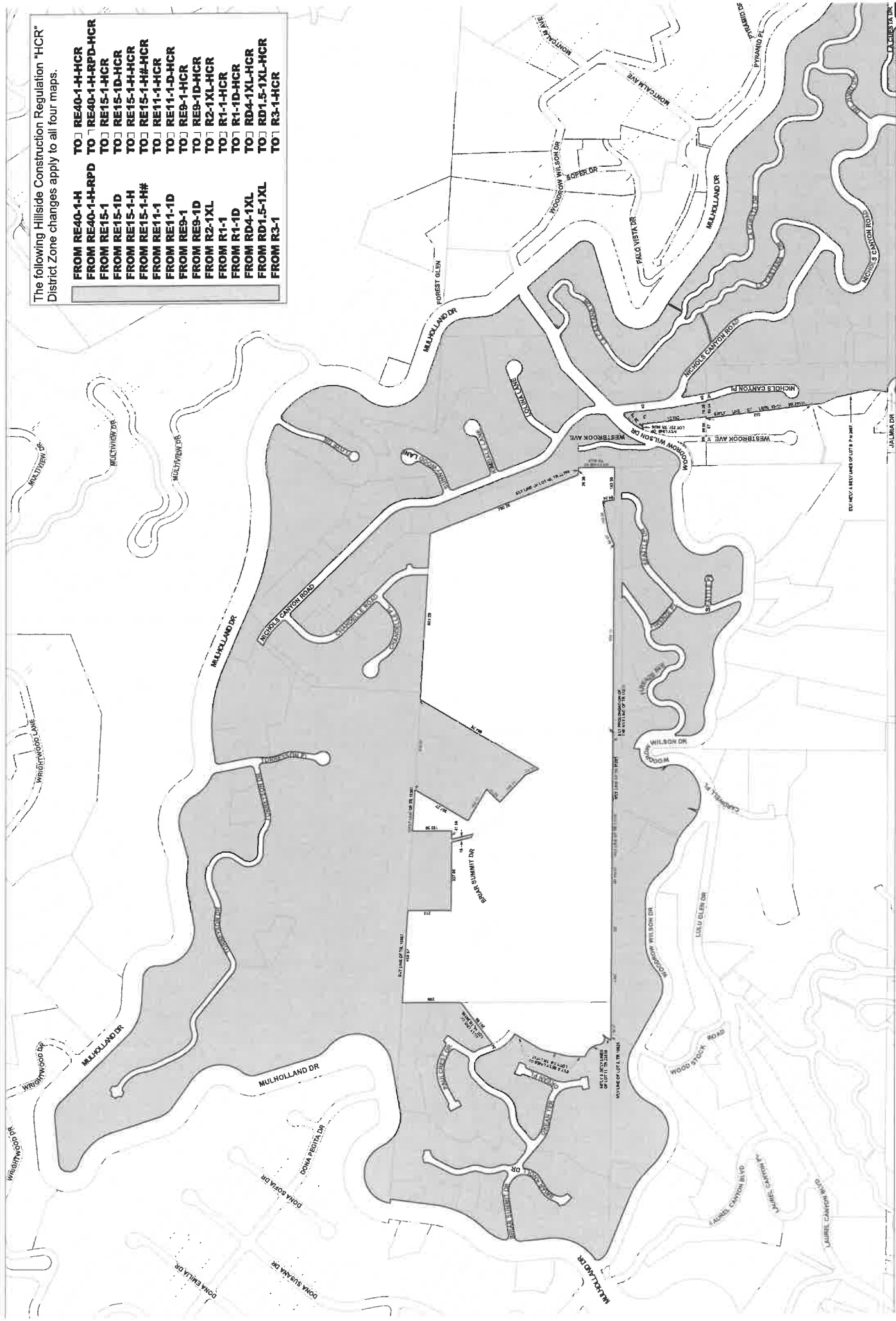

Map 1. Hillside Construction Regulation "HCR" District Zone Change

ALL ZONES AND HEIGHT DISTRICTS IN THE  
AFFECTED AREA REMAIN THE SAME. SUFFIX  
HCR WAS ADDED BECAUSE AREA IS NOW IN A  
HILLSIDE CONSTRUCTION REGULATION DISTRICT.



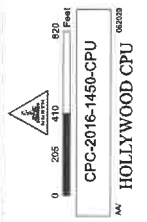
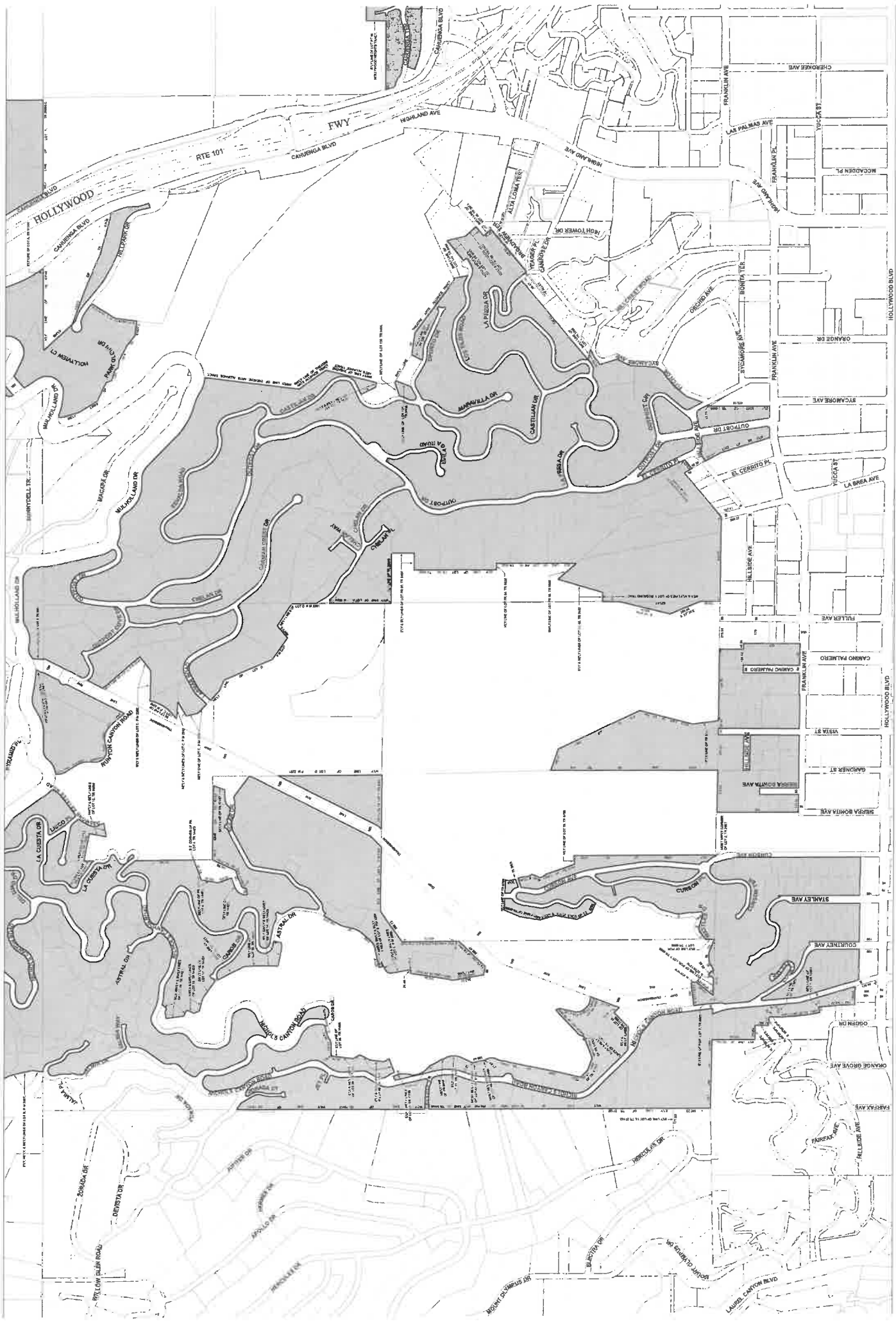

Map 2. Hillside Construction Regulation "HCR" District Zone Change

ALL ZONES AND HEIGHT DISTRICTS IN THE AFFECTED AREA REMAIN THE SAME. SUFFIX HCR WAS ADDED BECAUSE AREA IS NOW IN A HILLSIDE CONSTRUCTION REGULATION DISTRICT.

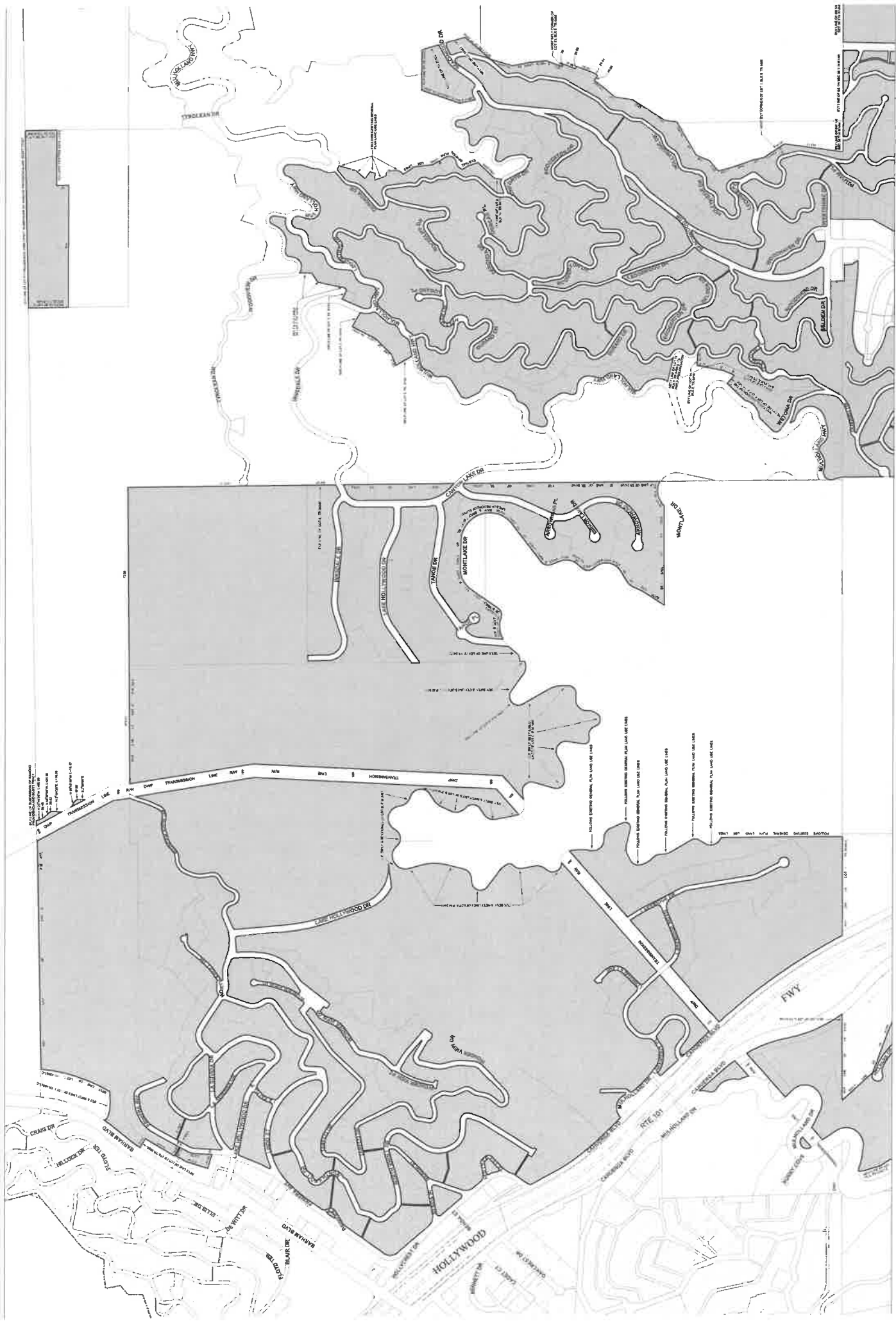

**Map 3. Hillside Construction Regulation "HCR" District Zone Change**

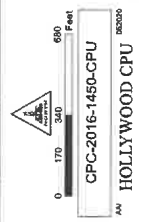

**Map 4. Hillside Construction Regulation "HCR" District Zone Change**

ALL ZONES AND HEIGHT DISTRICTS IN THE AFFECTED AREA REMAIN THE SAME. SUFFIX HCR WAS ADDED BECAUSE AREA IS NOW IN A HILLSIDE CONSTRUCTION REGULATION DISTRICT.

CPC-2016-1450-CPU  
AN HOLLYWOOD CPU

Sec. 3. The City Clerk shall certify to the passage of this ordinance and have it published in accordance with Council policy, either in a daily newspaper circulated in the City of Los Angeles or by posting for ten days in three public places in the City of Los Angeles: one copy on the bulletin board located at the Main Street entrance to the Los Angeles City Hall; one copy on the bulletin board located at the Main Street entrance to the Los Angeles City Hall East; and one copy on the bulletin board located at the Temple Street entrance to the Los Angeles County Hall of Records.

Approved as to Form and Legality

HYDEE FELDSTEIN SOTO, City Attorney

By   
KATHRYN PHELAN  
Deputy City Attorney

Date November 5, 2024

File No. \_\_\_\_\_

Pursuant to Charter Section 559, I  
**approve** this ordinance on behalf  
of the City Planning Commission and  
recommend that it be adopted.

  
VINCENT P. BERTONI, AICP  
Director of Planning

Date November 5, 2024

["M:\Real Prop\_Env\_Land Use\Land Use\Kathryn Phelan\Ordinances\Hollywood CPU\Ordinances\2024.09.06 HCR Amen Ord - Approval Backing Page.docx"]

The Clerk of the City of Los Angeles  
hereby certifies that the foregoing  
ordinance was passed by the Council  
of the City of Los Angeles.

CITY CLERK

MAYOR

\_\_\_\_\_

\_\_\_\_\_

Ordinance Passed \_\_\_\_\_

Approved \_\_\_\_\_